

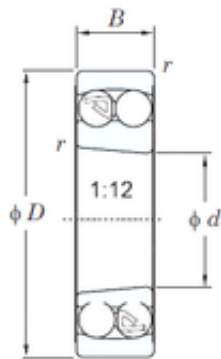

# BEARING BOWER CORP.

## 65 mm x 120 mm x 23 mm NU218ECM/C3VL0241 Bearing



Bearing No. 1213K

1213K Bearing 2D drawings and 3D CAD models

Size	65x120x23 mm
Bore Diameter	65 mm
Outer Diameter	120 mm
Width	23 mm
d	65 mm
D	120 mm
B	23 mm
C	23 mm
r min.	1.5 mm
da min.	73 mm
Da max.	112 mm
ra max.	1.5 mm
Weight	1.13 Kg
Basic dynamic load rating (C)	31.0 kN
Basic static load rating (C0)	12.5 kN
(Grease) Lubrication Speed	4800 r/min
(Oil) Lubrication Speed	5800 r/min
Calculation factor (e)	0.17
Calculation factor (Y0)	3.84
Calculation factor (Y1)	3.67
Category	Self Aligning Ball Bearings
Inventory	0.0
Manufacturer Name	KOYO
Minimum Buy Quantity	N/A
Weight / Kilogram	12.215



## BEARING BOWER CORP.

EAN	0605790001239
Product Group	B00152
Mounting Method	Tapered Adapter
Enclosure	Open
Rolling Element	Ball Bearing
Adapter Sleeve	H-213X
Cage Material	Steel
Precision Class	ABEC 1   ISO P0
Internal Clearance	C0-Medium
Number of Rows of Balls	Double Row
Other Features	Allowable Misalignment 2.5 Deg   1:12 Taper
Long Description	65MM Bore; Tapered Adapter Mount; 120MM Outside Diameter; 23MM Inner Race Width; 23MM Outer Race Width; Open; Steel Cage; Double Row of Balls; ABEC 1   ISO P0; C0-Medium
Inch - Metric	Metric
Category	Self Aligning Ball Bearings
UNSPSC	31171532
Harmonized Tariff Code	8482.10.50.68
Noun	Bearing
Keyword String	Self Aligning
Manufacturer URL	<a href="http://www.koyousa.com">http://www.koyousa.com</a>
Manufacturer Item Number	1213K
Weight / LBS	2.49122
Inner Race Width	0.906 Inch   23 Millimeter
Bore	2.559 Inch   65 Millimeter
Outer Race Width	0.906 Inch   23 Millimeter
Outside Diameter	4.724 Inch   120 Millimeter