

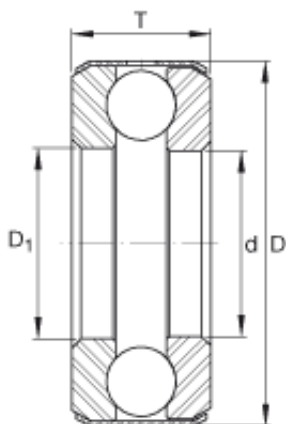

BEARING BOWER CORP.



RN203 Eccentric Bearing 17x33.9x12mm

Bearing No. D2

Size	14.288x30.963x14.3 mm
Bore Diameter	14,288 mm
Outer Diameter	30,963 mm
Width	14,3 mm
d	9/16 inch
d	14,288 mm
D	1,219 inch
D	30,963 mm
T	0,563 inch
T	14,3 mm
D ₁	0,594 inch
m	0,11 lbs / Weight
m	51 g / Weight
C _a	3850 lbf / Dynamic load rating (axial)
C _a	17100 N / Dynamic load rating (axial)
C _{0a}	5600 lbf / Static load rating (axial)
C _{0a}	24900 N / Static load rating (axial)
Category	Thrust Ball Bearing
Inventory	1.0
Manufacturer Name	SCHAEFFLER GROUP
Minimum Buy Quantity	N/A
Weight / Kilogram	0.05
EAN	4012802034486

D2 Bearing 2D drawings and 3D CAD models



BEARING BOWER CORP.

Product Group	B00308
Rolling Element	Ball Bearing
Thrust Bearing	Yes
Single or Double Direction	Single Direction
Banded	Yes
Precision Class	ABEC 1 ISO P0
Component Description	Roller Assembly Plus Raceways
Other Features	Single Row Deep Groove Medium Cross Section Grooved Race Non Separable Full Complement Standard Oil Hole in Band
Long Description	9/16" Bore 1; 19/32" Bore 2; 1-7/32" Outside Diameter; 9/16" Height; Ball Bearing; Single Direction; Banded; ABEC 1 ISO P0 Precision
Inch - Metric	Inch
Category	Thrust Ball Bearings
UNSPSC	31171507
Harmonized Tariff Code	8482.10.50.08
Noun	Bearing
Keyword String	Ball Thrust
Manufacturer URL	http://www.ina.com
Manufacturer Item Number	D2HLG
Weight / LBS	0.11
Bore 2	0.594 Inch 15.088 Millimeter
Height	0.563 Inch 14.3 Millimeter
Outside Diameter	1.219 Inch 30.963 Millimeter
Bore 1	0.563 Inch 14.3 Millimeter
Overall Height with Aligning Washer	0 Inch 0 Millimeter



BEARING BOWER CORP.