

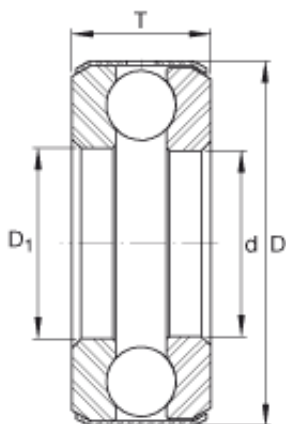

BEARING BOWER CORP.

300752904K2 Eccentric Bearing 19x53.5x32mm



Bearing No. D16

Size	36.513x65.888x15.875 mm
Bore Diameter	36,513 mm
Outer Diameter	65,888 mm
Width	15,875 mm
d	1 7/16 inch
d	36,513 mm
D	2,469 inch
D	65,888 mm
T	0,625 inch
T	15,875 mm
D ₁	1,469 inch
m	0,42 lbs / Weight
m	190 g / Weight
C _a	7300 lbf / Dynamic load rating (axial)
C _a	32500 N / Dynamic load rating (axial)
C _{0a}	16600 lbf / Static load rating (axial)
C _{0a}	74000 N / Static load rating (axial)
Category	Thrust Ball Bearing
Inventory	0.0
Manufacturer Name	SCHAEFFLER GROUP
Minimum Buy Quantity	N/A
Weight / Kilogram	0.19
EAN	4012802034448

D16 Bearing 2D drawings and 3D CAD models



BEARING BOWER CORP.

Product Group	B00308
Rolling Element	Ball Bearing
Thrust Bearing	Yes
Single or Double Direction	Single Direction
Banded	Yes
Precision Class	ABEC 1 ISO P0
Component Description	Roller Assembly Plus Raceways
Other Features	Single Row Deep Groove Medium Cross Section Grooved Race Non Separable Full Complement Standard Oil Hole in Band
Long Description	1-7/16" Bore 1; 1-15/32" Bore 2; 2-15/32" Outside Diameter; 5/8" Height; Ball Bearing; Single Direction; Banded; ABEC 1 ISO P0 Precision
Inch - Metric	Inch
Category	Thrust Ball Bearings
UNSPSC	31171507
Harmonized Tariff Code	8482.10.50.08
Noun	Bearing
Keyword String	Ball Thrust
Manufacturer URL	http://www.ina.com
Manufacturer Item Number	D16
Weight / LBS	0.42
Overall Height with Aligning Washer	0 Inch 0 Millimeter
Height	0.625 Inch 15.875 Millimeter
Outside Diameter	2.469 Inch 62.713 Millimeter
Bore 1	1.438 Inch 36.525 Millimeter



BEARING BOWER CORP.

Bore 2

1.469 Inch | 37.313
Millimeter